

PROJECT 10073 RECORD

1. DATE - TIME GROUP 14 Sept 68 14/2100CDT 15/0100Z	2. LOCATION Kewonna, Indiana (Multiple)
3. SOURCE Civilian	10. CONCLUSION Probable Astro (ARCTURUS)
4. NUMBER OF OBJECTS Two	
5. LENGTH OF OBSERVATION 90 Minutes	11. BRIEF SUMMARY AND ANALYSIS The observer sighted what ^{AT} first appeared to be a star. "Of course the stars were out and it was quite dark out. This object seemed very red and orange by just looking up at it. Of course through the binoculars. We seen flashes off and on." The object was seen fairly low in the WSW and last seen in the WNW. The observer also saw another similar light to the S.
6. TYPE OF OBSERVATION Ground-Visual (BX)	
7. COURSE See Case	COMMENTS: There was a temperature inversion in the area at the time. Base Control Tower stated that a bright star or planet was in the night sky in the general bearing of the reported "UFO". Initially Arcturus was at approximately 17 deg elevation, 281 deg azimuth, at the end of the sighting it would have been at about 3 deg elevation, 295 deg azimuth. Thus the first object was probable Arcturus and the second
8. PHOTOS <input type="checkbox"/> Yes <input checked="" type="checkbox"/> No	
9. PHYSICAL EVIDENCE <input type="checkbox"/> Yes <input checked="" type="checkbox"/> No	object also a Star/Planet but there wasn't enough information to identify it.

27. INFORMATION WHICH YOU FEEL IS PERTINENT BUT WHICH IS NOT ADEQUATELY COVERED IN THIS QUESTIONNAIRE, ALTERNATIVELY PROVIDE A NARRATIVE EXPLANATION OF THE SIGHTING.

My next door neighbor Mr. [REDACTED] first sighted only one flying object, which he thought was a falling star. When it stopped moving, he got his pair of binoculars and watched. It had come from the south at a rapid rate of speed. He called, to us to see this object, which appeared round and had a constant glow around it. It seemed to me to have green and red lights around the base. Also there seemed to be a lot of orange flashes from the sides. The object moved up and down at a very slow rate. It moved below our tree line and then returned to the original position.

Mr. [REDACTED] went back to his home. My husband and two boys stayed outside and watched. During the time Mr. [REDACTED] was with us, my husband made the remark, Maybe we should call the Air Base. No one seemed to move, so I did call myself. I do know the object had to be seen over an hour.

When my husband and I saw a plane coming from the West. Both objects immediately left.

When I walked out to the road to get a better view of the one, we were watching, I noticed another one and called to Mr. [REDACTED], Mrs. [REDACTED] and her husband. They also saw the second one.

FROM: DCOI

4 October 1968

SUBJ: UFO Sighting

TO: FTD (TDETR)
Wright Patterson AFB, Ohio

1. The attached AF Form 117 is forwarded to you IAW AFR 80-17.

2. Our base investigation revealed the following:

a. Base Control Tower personnel stated that a bright star or planet was in the night sky in the general bearing of the reported "UFO" (Kewanna, Ind).

b. Base RApCon (Radar Approach Control) personnel stated that there was a temperature inversion phenomenon noted on their radar scopes in the direction of Kewanna during the period of the "UFO" sighting and may have been the source of the appearance of reflected lights.

c. No further investigation was made into this reported sighting.



OMA B. CARTWRIGHT, Lt Col, USAF
Chief, Intelligence Division

SIGHTING OF UNIDENTIFIED PHENOMENA QUESTIONNAIRE

BUDGET BUREAU APPROVAL
NUMBER 21-R258

THIS QUESTIONNAIRE HAS BEEN PREPARED SO THAT YOU CAN GIVE THE U.S. AIR FORCE AS MUCH INFORMATION AS POSSIBLE CONCERNING THE UNIDENTIFIED PHENOMENON THAT YOU HAVE OBSERVED. PLEASE TRY TO ANSWER ALL OF THE QUESTIONS. THE INFORMATION YOU GIVE WILL BE USED FOR RESEARCH PURPOSES. YOUR NAME WILL NOT BE USED IN CONNECTION WITH ANY OF YOUR STATEMENTS OR CONCLUSIONS WITHOUT YOUR PERMISSION. RETURN TO AIR FORCE BASE INVESTIGATOR FOR FORWARDING TO FTI (TDETR), WRIGHT-PATTERSON AFB, OHIO 45433, 1AW AFR 80-17. (IF ADDITIONAL SHEETS ARE NEEDED FOR NARRATIVE OR SKETCHES ATTACH SECURELY TO THIS FORM OR ANNOTATE WITH YOUR NAME FOR IDENTIFICATION.)

1. WHEN DID YOU SEE THE PHENOMENON?

DAY 14th MONTH Sept. YEAR 1968

2. WHAT TIME DID YOU FIRST SIGHT THE PHENOMENON?

HOUR 9:00 MINUTES _____ A.M. P.M.

3. WHAT TIME DID YOU LAST SIGHT THE PHENOMENON?

HOUR 10:00 MINUTES 30 A.M. P.M.

4. TIME / ZONE

DAYLIGHT SAVINGS

STANDARD

EASTERN

CENTRAL

MOUNTAIN

PACIFIC

OTHER

5. WHERE WERE YOU WHEN YOU SAW THE PHENOMENON? IF IN CITY, GIVE THE NEAREST STREET ADDRESS AND INDICATE ON A HAND DRAWN MAP WHERE YOU WERE STANDING WITH REFERENCE TO THE ADDRESS. IF IN THE COUNTRY, IDENTIFY THE HIGHWAY YOU WERE ON OR NEAR AND TRY TO FIX A DISTANCE AND DIRECTION FROM SOME RECOGNIZABLE LANDMARK.

We were standing in our back yard. We live on the south side of Lake Bruce. The fourth house at the end of the road going east.

WEST

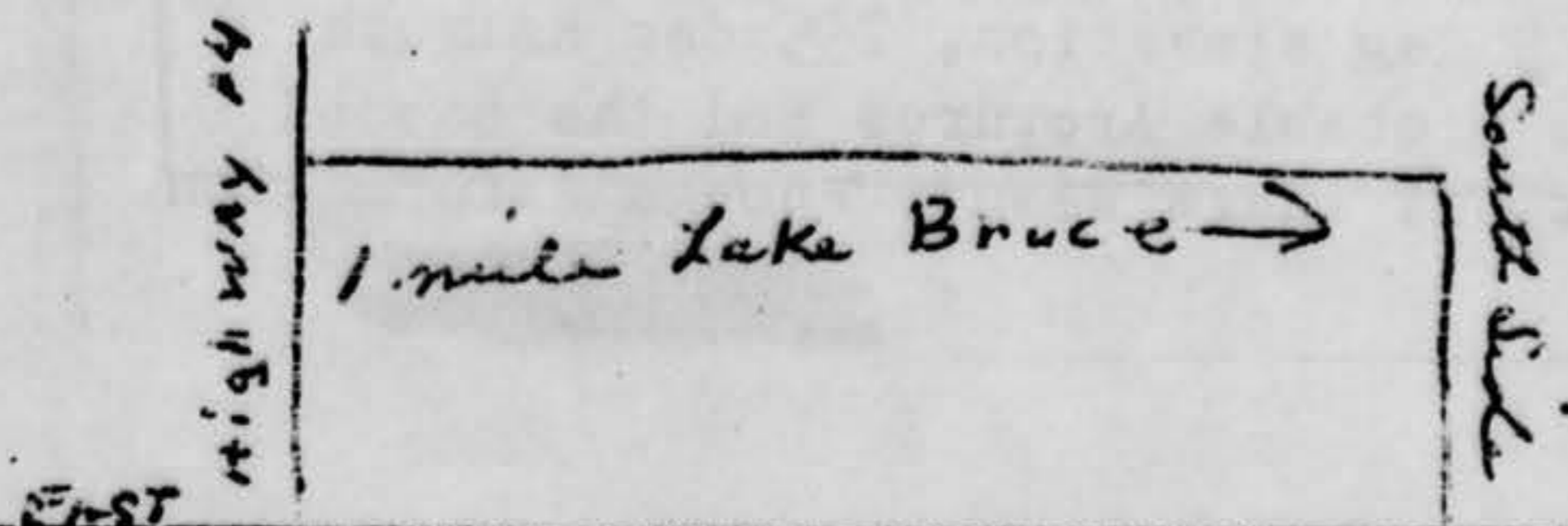

6. IMAGINE YOU ARE AT THE POINT SHOWN IN THE SKETCH. PLACE AN "A" ON THE CURVED LINE TO SHOW HOW HIGH THE PHENOMENON WAS ABOVE THE HORIZON, OR SKYLINE, WHEN FIRST SEEN. PLACE A "B" ON THE SAME CURVED LINE TO SHOW HOW HIGH ABOVE THE HORIZON THE PHENOMENON WAS WHEN LAST SEEN.

It was last seen at "A" when it disappeared.

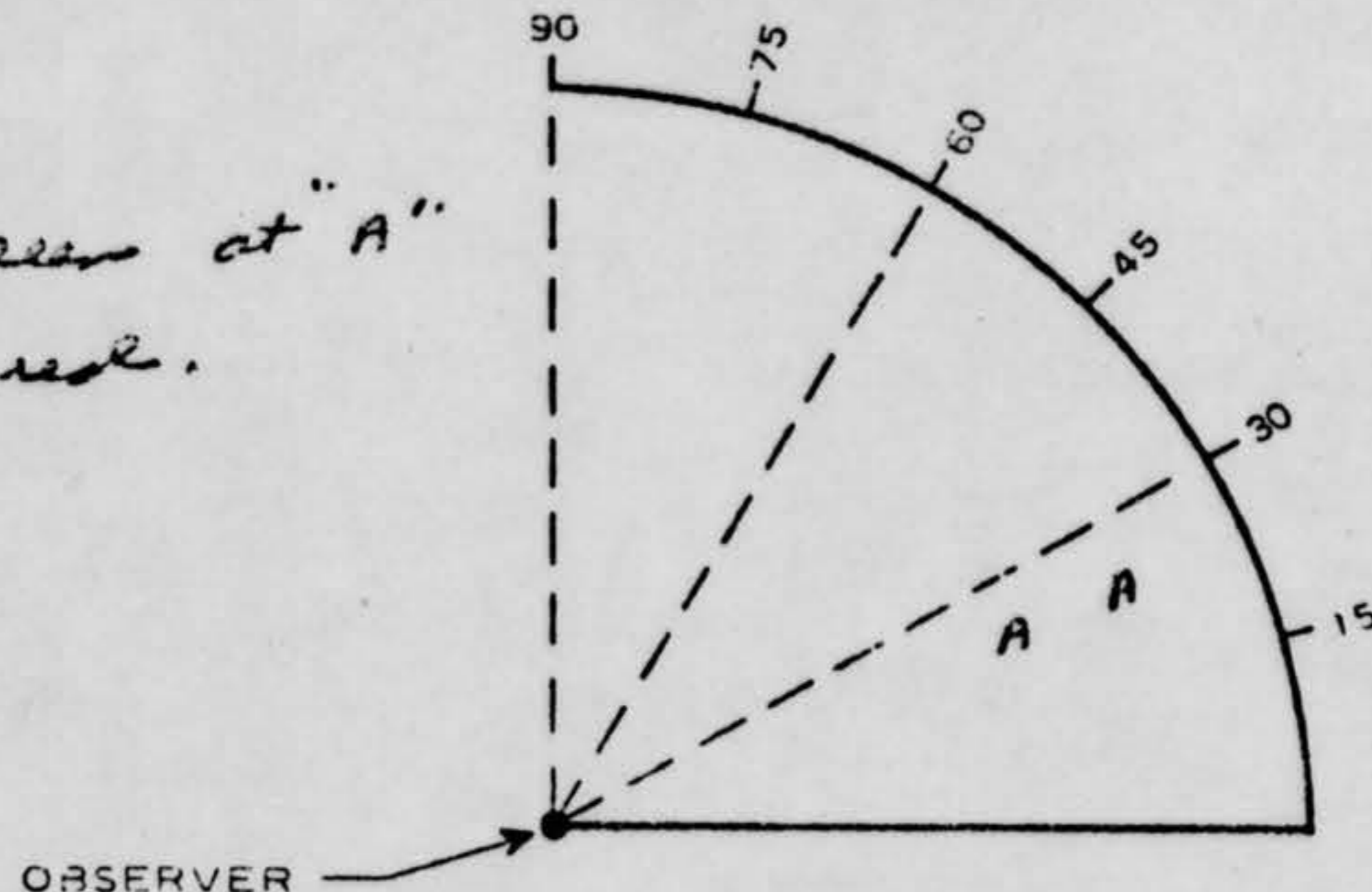

Lat 40° 30'

6A. NOW IMAGINE YOU ARE AT THE CENTER OF THE COMPASS ROSE. PLACE AN "A" ON THE COMPASS TO INDICATE THE DIRECTION TO THE PHENOMENON WHEN FIRST SEEN. PLACE A "B" ON THE COMPASS TO INDICATE THE DIRECTION TO THE PHENOMENON WHEN LAST SEEN.

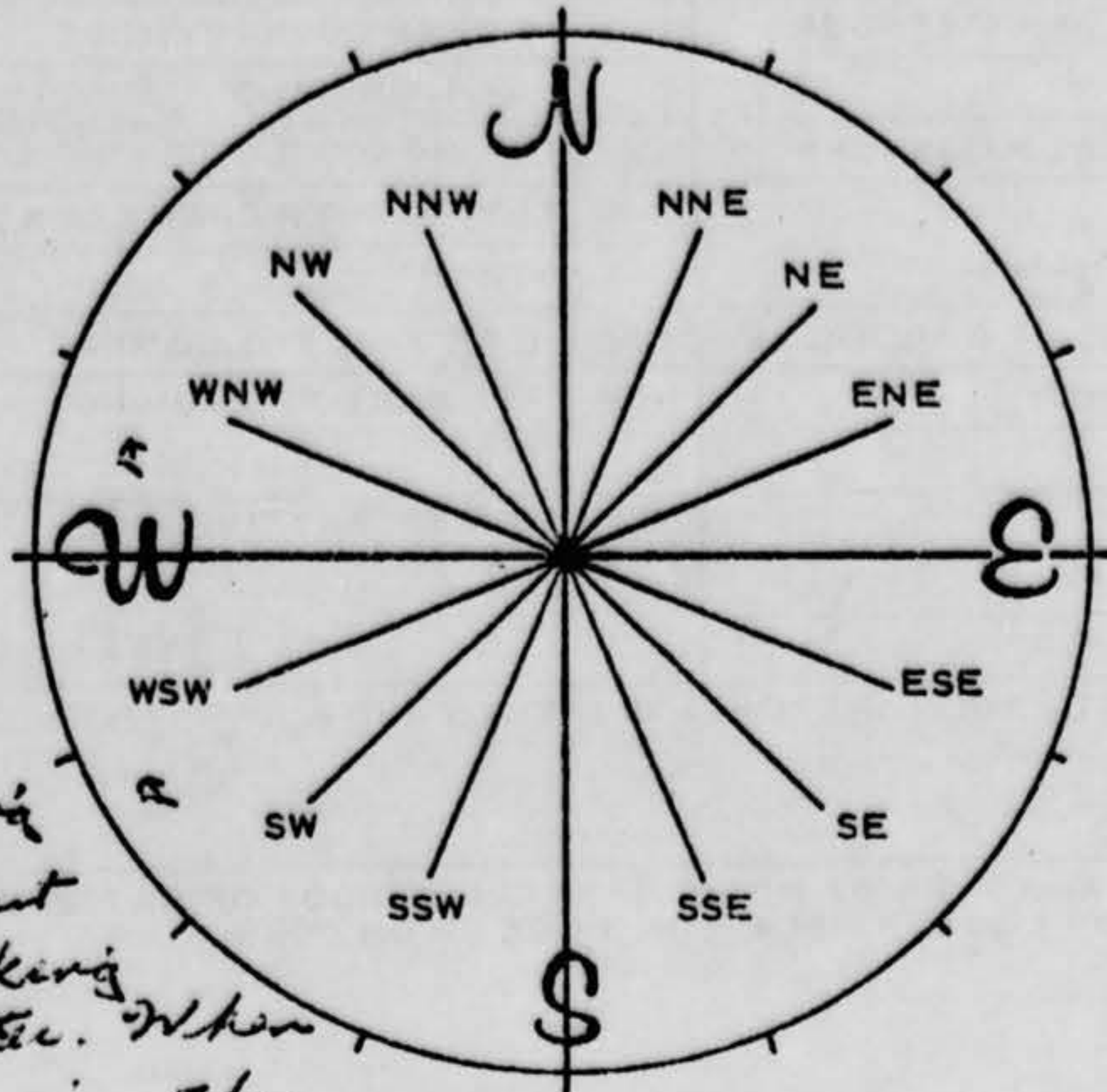

There were two of them, after watching the one. I walked out to the road. Thinking I could see it better. When I noticed the one in the direction south.

7. IN THE SKETCH BELOW, PLACE AN "A" AT THE POSITION OF THE PHENOMENON WHEN FIRST SEEN, AND A "B" AT THE POSITION OF THE PHENOMENON WHEN LAST SEEN. CONNECT THE "A" AND "B" WITH A LINE TO APPROXIMATE THE MOVEMENT OF THE PHENOMENON BETWEEN "A" AND "B". THAT IS, SCHEMATICALLY SHOW WHETHER THE MOVEMENT APPEARED TO BE STRAIGHT, CURVED OR ZIG-ZAG. REFER TO SMALLER SKETCH AS AN EXAMPLE OF HOW TO COMPLETE THE LARGER SKETCH.

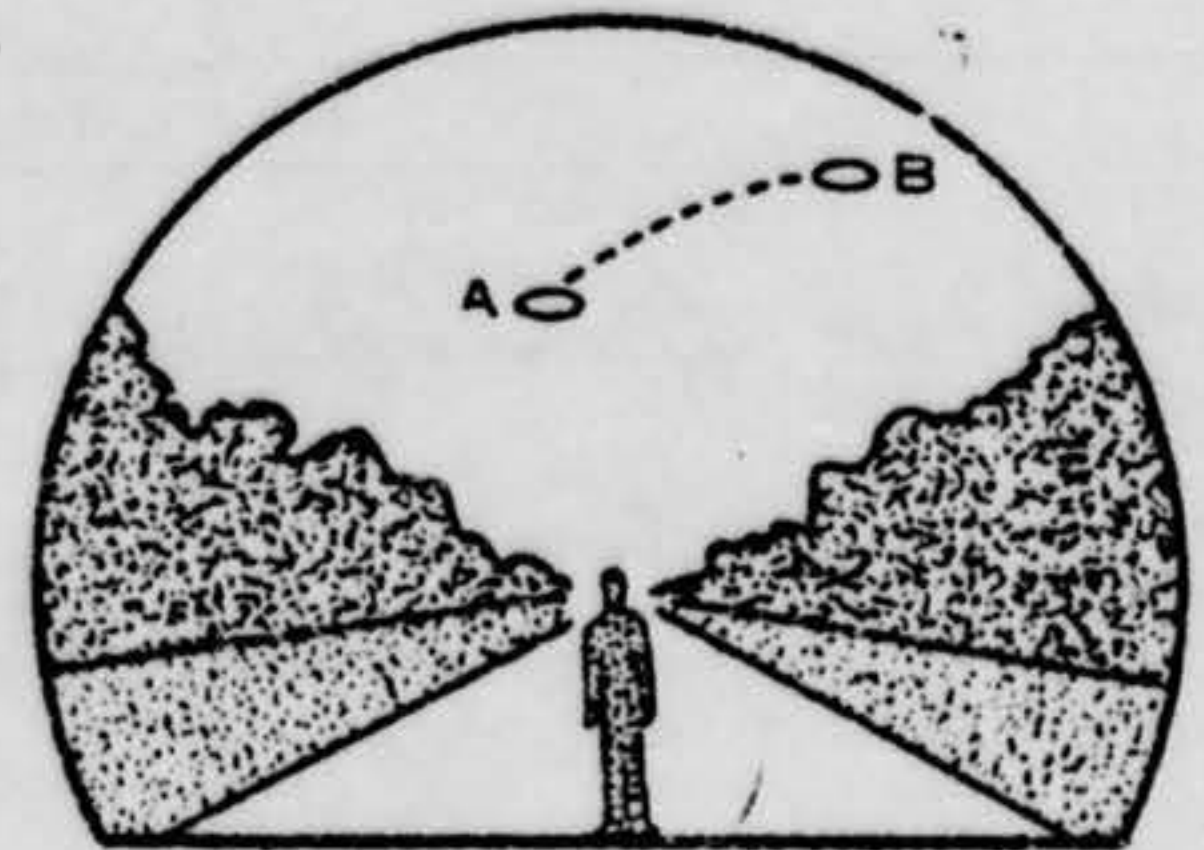
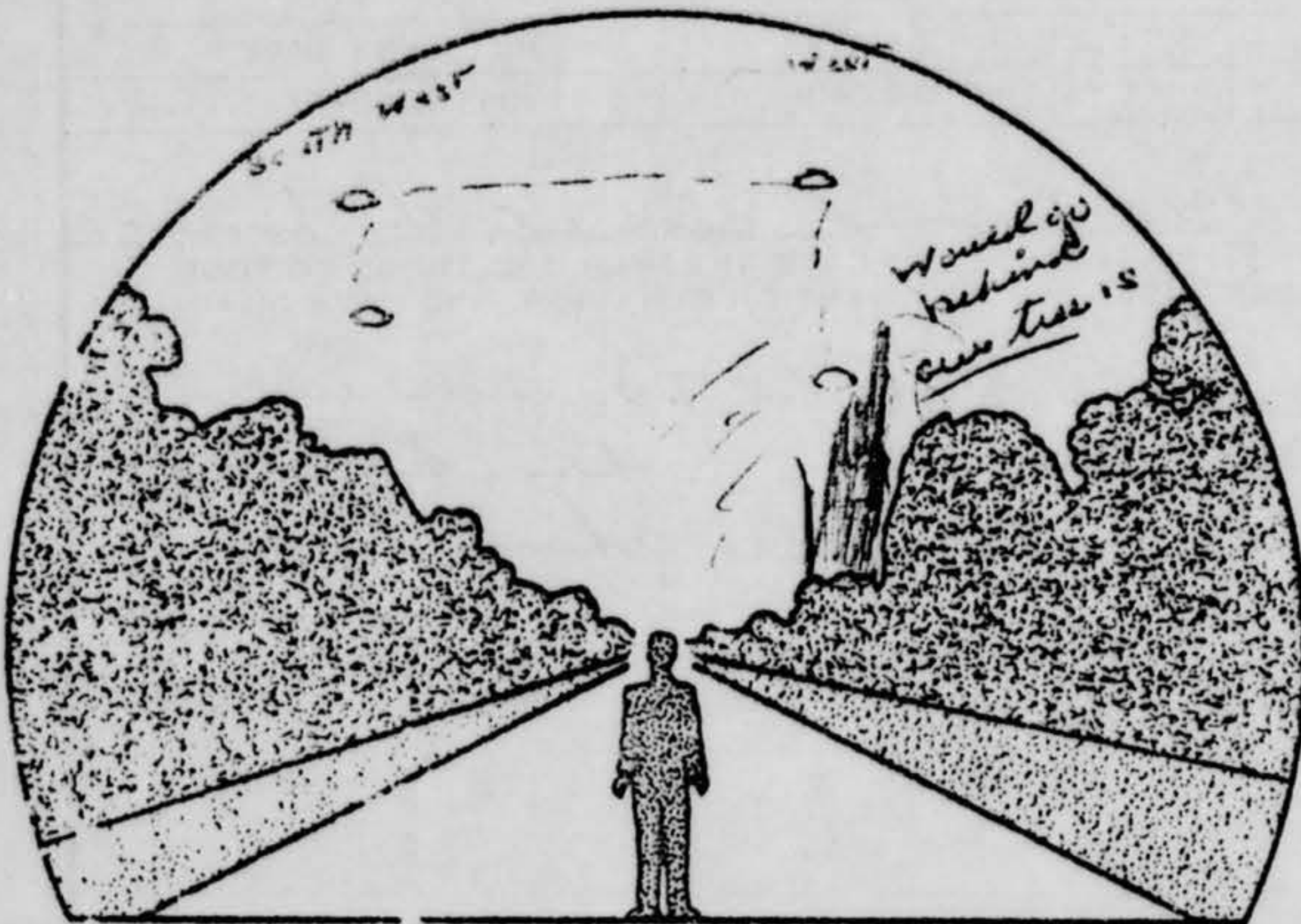

*Kept moving up and down
This I could see
without binoculars.*

8. WHERE WERE YOU WHEN YOU SAW THE PHENOMENON? (Check appropriate blocks.)

<input checked="" type="checkbox"/> OUTDOORS		IN BUSINESS SECTION OF CITY
IN BUILDING		IN RESIDENTIAL SECTION OF CITY
IN CAR <input type="checkbox"/> AS DRIVER <input type="checkbox"/> AS PASSENGER		IN OPEN COUNTRYSIDE
IN BOAT		NEAR AIRFIELD
IN AIRPLANE <input type="checkbox"/> AS PILOT <input type="checkbox"/> AS PASSENGER		FLYING OVER CITY
OTHER	<input checked="" type="checkbox"/>	FLYING OVER OPEN COUNTRY
<i>Sitting in our back yard.</i>		OTHER

A. IF YOU WERE IN A VEHICLE, COMPLETE THE FOLLOWING:

WHAT DIRECTION WERE YOU MOVING?		HOW FAST WERE YOU MOVING?
NORTH	EAST	DID YOU STOP ANYTIME WHILE OBSERVING THE PHENOMENON? <input type="checkbox"/> YES <input type="checkbox"/> NO
SOUTH	WEST	
NORTHEAST	SOUTHEAST	
NORTHWEST	SOUTHWEST	

EXPLAIN WHETHER SUCH MOVEMENT AFFECTS YOUR SKETCHES IN ITEMS 5 AND 6.

DESCRIBE TYPE OF VEHICLE YOU WERE IN AND TYPE OF ROAD, TERRAIN OR BODY OF WATER YOU TRAVERSED DURING THE SIGHTING. STATE WHETHER WINDOWS OR CONVERTIBLE TOP WERE UP OR DOWN.

HOW MUCH OTHER TRAFFIC WAS THERE?

DID YOU NOTICE ANY AIRPLANES? YES NO. IF "YES," DESCRIBE WHEN THEY WERE IN SIGHT RELATIVE TO THE TIME OF SIGHTING THE PHENOMENON AND WHERE THEY WERE IN THE SKY RELATIVE TO THE POSITION OF THE PHENOMENON.

after watching the objects over an hour, a plane came from the west going east. The objects left. I didn't notice a movement up or down. Just gone.

9. HOW LONG WAS THE PHENOMENON IN SIGHT?

LENGTH OF TIME	<input checked="" type="checkbox"/> CERTAIN OF TIME	<input type="checkbox"/> NOT VERY SURE
<i>About from 9 to 10:30</i>	<input type="checkbox"/> FAIRLY CERTAIN	<input type="checkbox"/> JUST A GUESS

HOW WAS TIME DETERMINED?

Watching a certain TV program. My husband ^{came} back into the house.

WAS THE PHENOMENON IN SIGHT CONTINUOUSLY? YES NO. IF "NO," INDICATE WHETHER THIS IS DUE TO YOUR MOVEMENT OR THE BEHAVIOR OF THE PHENOMENON, AND DESCRIBE SUCH MOVEMENT OR BEHAVIOR. INDICATE DISAPPEARANCES ON PREVIOUS SKETCHES.

I left my home at 10:30 P.M. To pick up my son in Kewanna. It was 10:30 when he called. The objects had just left when our phone rang.

10. IF THERE WERE MORE THAN ONE PHENOMENON, HOW MANY WERE THERE? DRAW A PICTURE TO SHOW HOW THEY WERE ARRANGED. DID THIS ARRANGEMENT CHANGE DURING THE SIGHTING?

There were two
 This one seemed
 to stay in one place
 more.

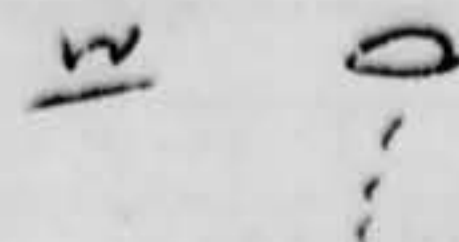
W 
 moved up
 and down
 changed color
 disappear and
 reappear.

11. CONDITIONS (Check appropriate blocks.)

A. SKY		B. WEATHER	
<input type="checkbox"/> DAY		<input type="checkbox"/> CUMULUS CLOUDS (Low fluffy)	<input type="checkbox"/> FOG OR MIST
<input type="checkbox"/> TWILIGHT		<input type="checkbox"/> CIRRUS CLOUDS (High fleecy or Herring-bone)	<input type="checkbox"/> HEAVY RAIN
<input checked="" type="checkbox"/> NIGHT		<input type="checkbox"/> NIMBUS CLOUDS (Rain)	<input type="checkbox"/> LIGHT RAIN OR DRIZZLE
<input type="checkbox"/> CLEAR		<input type="checkbox"/> CUMULONIMBUS CLOUDS (Thunderstorms)	<input type="checkbox"/> HAIL
<input type="checkbox"/> PARTLY CLOUDY		<input type="checkbox"/> HAZE OR SMOG	<input type="checkbox"/> SNOW OR SLEET
<input type="checkbox"/> COMPLETELY OVERCAST			<input type="checkbox"/> UNKNOWN
			<input type="checkbox"/> NONE OF THE ABOVE

C. IF THE SIGHTING WAS AT TWILIGHT OR NIGHT, WHAT DID YOU NOTICE ABOUT THE STARS AND MOON? *Stars very bright*

(1) STARS	(2) MOON
<input type="checkbox"/> NONE	<input type="checkbox"/> BRIGHT MOONLIGHT
<input type="checkbox"/> A FEW	<input type="checkbox"/> MOON WITH HALO
<input checked="" type="checkbox"/> MANY	<input checked="" type="checkbox"/> NO MOONLIGHT
<input type="checkbox"/> UNKNOWN	<input type="checkbox"/> UNKNOWN
	<input type="checkbox"/> MOON HIDDEN BY CLOUDS
	<input type="checkbox"/> PARTIAL (New or quarter)

D. IF SIGHTING WAS IN DAYLIGHT, WAS THE SUN VISIBLE? YES NO. IF "YES," WHERE WAS THE SUN AS YOU FACED THE PHENOMENON?

<input type="checkbox"/> IN FRONT OF YOU	<input type="checkbox"/> TO YOUR RIGHT	<input type="checkbox"/> OVERHEAD (Near noon)
<input type="checkbox"/> IN BACK OF YOU	<input type="checkbox"/> TO YOUR LEFT	<input type="checkbox"/> UNKNOWN

E. SPECIFY THE MAJOR SOURCE OF ILLUMINATION PRESENT DURING THE SIGHTING, SUCH AS THE SUN, HEADLIGHTS OR STREET LAMP, ETC. FOR TERRESTRIAL ILLUMINATION, SPECIFY DISTANCE TO LIGHT SOURCE.

12. GIVE A BRIEF DESCRIPTION OF THE PHENOMENON, INDICATING WHETHER IT APPEARED DARK OR LIGHT, WHETHER IT REFLECTED LIGHT OR WAS SELF-LUMINOUS AND WHAT COLORS YOU NOTICED. DESCRIBE YOUR IMPRESSION OF WHETHER IT WAS SOLID OR TRANSPARENT, WHETHER EDGES WERE SHARP OR FUZZY. DESCRIBE THE SHAPE OR INDICATE IF IT APPEARED AS A POINT OF LIGHT. INDICATE COMPARISONS WITH OTHER OBSERVED OBJECTS, LIKE STARS, A LIGHT OR OTHER OBJECT IN YOUR FIELD OF VIEW.

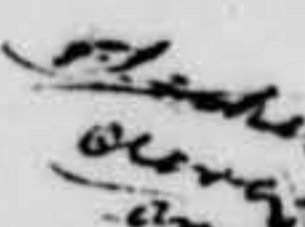
Flasher orange and white sharp edges 
Flasher orange and white 
 It appeared very bright red with out Binoculars.

13.	DID THE PHENOMENON	YES	NO	UNKNOWN
	MOVE IN A STRAIGHT LINE?	✓		
	STAND STILL AT ANYTIME?			
	SUDDENLY SPEED UP AND RUN AWAY?	✓		
	BREAK UP IN PARTS AND EXPLODE?			
	CHANGE COLOR?	✓		
	GIVE OFF SMOKE?			
	CHANGE BRIGHTNESS?	✓		
	CHANGE SHAPE?			
	FLASH OR FLICKER?	✓		
	DISAPPEAR AND REAPPEAR?	✓		
	SPIN LIKE A TOP?	✓		
	MAKE A NOISE?			
	FLUTTER OR WOBBLE?	✓		

14. WHAT DREW YOUR ATTENTION TO THE PHENOMENON?

When our neighbors called, to us to come out side and look up at the stars. Mr. Rinckel said, it came such a rapid rate of speed. Then it stopped. He asked, us what we thought of it?

A. HOW DID IT FINALLY DISAPPEAR?

When a plane flew over. Both of the objects.

B. DID THE PHENOMENON MOVE BEHIND OR IN FRONT OF SOMETHING, LIKE A CLOUD, TREE, OR BUILDING AT ANY TIME?
 YES NO. IF "YES," DESCRIBE.

It moved back about some distance, below the tree line, and then returned to the original position.

15. DRAW A PICTURE THAT WILL SHOW THE SHAPE OF THE PHENOMENON. INCLUDE AND LABEL ANY DETAILS THAT MIGHT HAVE APPEARED AS WINGS OR PROTRUSIONS, AND INDICATE EXHAUST OR VAPOR TRAILS. INDICATE BY AN ARROW THE DIRECTION THE PHENOMENON WAS MOVING.

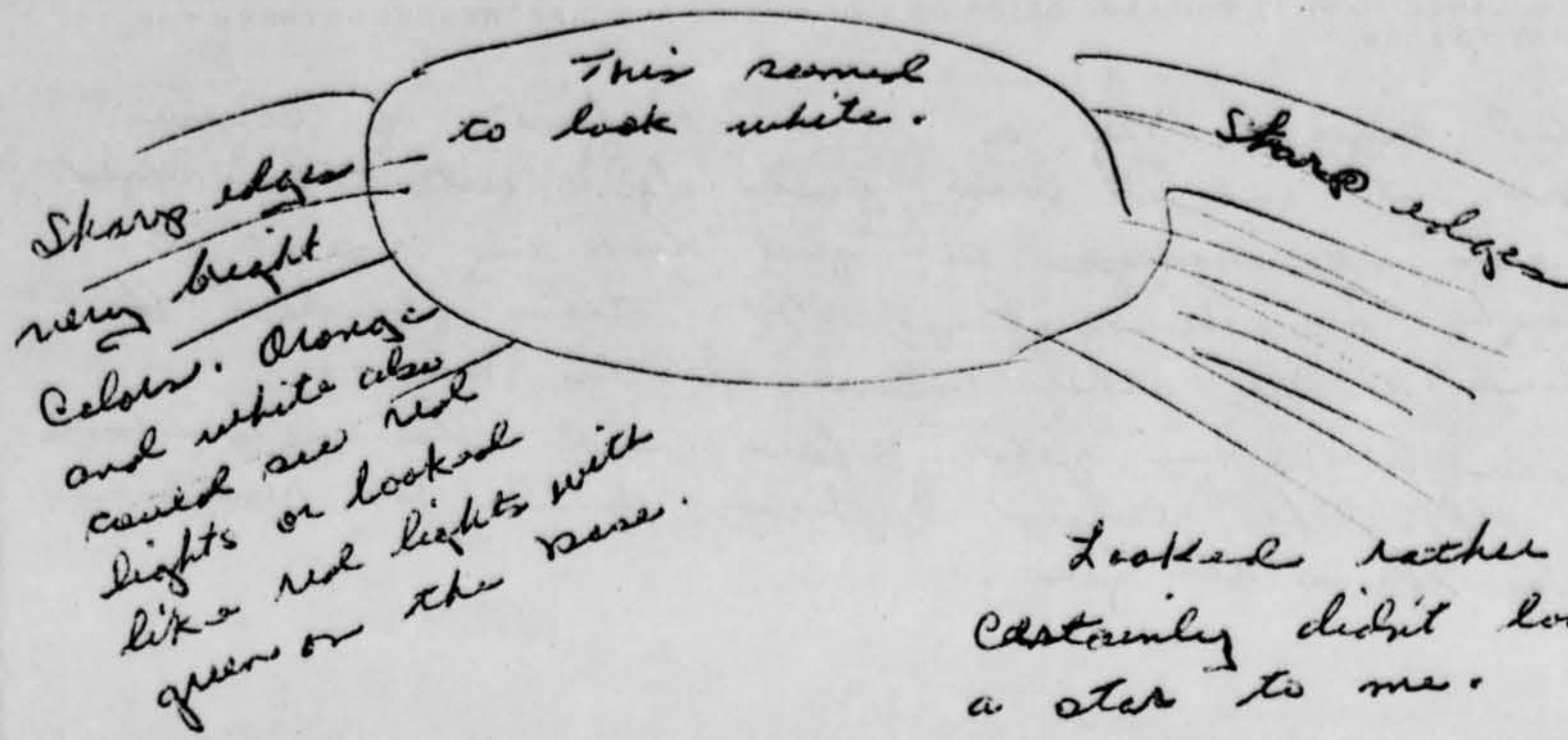

Looked rather large. Certainly didn't look like a star to me.

It looked like it might come down. Start to come down and then go right back again.

16. WHAT WAS THE ANGULAR SIZE? HOLD A MATCH AT ARM'S LENGTH IN FRONT OF A KNOWN OBJECT, SUCH AS A STREET LAMP OR THE MOON. NOTE HOW MUCH OF THE OBJECT IS COVERED BY THE HEAD OF THE MATCH. NOW IF YOU HAD BEEN ABLE TO PERFORM THIS EXPERIMENT AT THE TIME OF THE SIGHTING, ESTIMATE WHAT FRACTION OF THE PHENOMENON WOULD HAVE BEEN COVERED BY THE MATCH HEAD.

17. DID YOU OBSERVE THE PHENOMENON THROUGH ANY OF THE FOLLOWING? INCLUDE INFORMATION ON MODEL, TYPE, FILTER, LENS PRESCRIPTION OR OTHER APPLICABLE DATA.

EYEGASSES		CAMERA VIEWER
SUNGLASSES	<input checked="" type="checkbox"/>	BINOCULARS
WINDSHIELD		TELESCOPE
SIDE WINDOW OF VEHICLE		THEODOLITE
WINDOWPANE		OTHER

A. DO YOU ORDINARILY WEAR GLASSES? YES NO

B. DO YOU USE READING GLASSES? YES NO

18. WHAT WAS YOUR IMPRESSION OF THE SPEED OF THE PHENOMENON? GIVE ESTIMATE OF SPEED *Very, very fast*

19. WHAT WAS YOUR IMPRESSION OF THE DISTANCE OF THE PHENOMENON? GIVE ESTIMATE OF DISTANCE *10-20 miles*

20. IN ORDER THAT WE MAY OBTAIN AS CLEAR A PICTURE AS POSSIBLE OF WHAT YOU SAW, DESCRIBE IN YOUR OWN WORDS A COMMON OBJECT OR OBJECTS WHICH, WHEN PLACED IN THE SKY, SIMILAR TO WHERE YOU NOTED THE PHENOMENON, WOULD BEAR SOME RESEMBLANCE TO WHAT YOU SAW. DESCRIBE SIMILARITIES AND DIFFERENCES BETWEEN THE COMMON OBJECT AND WHAT YOU SAW.

It did seem to be a star at first. Of course the stars were out and it was quite dark out. This object seemed very red and changes by just looking up at it. Of course through the Binoculars. We saw flashes off and on. Seemed to be other colors at the base.

I have been in jets before and have watched them take off. The colors I have seen. No resemble me of the fire from the jets.

21. DID YOU NOTICE ANY ODOR, NOISE, OR HEAT EMANATING FROM THE PHENOMENON OR ANY EFFECT ON YOURSELF, ANIMALS OR MACHINERY IN THE VICINITY? YES NO. IF "YES," DESCRIBE.

A. DID THE PHENOMENON DISTURB THE GROUND OR LEAVE ANY PHYSICAL EVIDENCE. YES NO. IF "YES," DESCRIBE.

22. HAVE YOU EVER SEEN THIS OR A SIMILAR PHENOMENON BEFORE? YES NO. IF "YES," GIVE DATE AND LOCATION.

23. WAS ANYONE WITH YOU AT THE TIME YOU SAW THE PHENOMENON? YES NO. IF "YES," DID THEY SEE IT TOO?
 YES NO.

A. LIST THEIR NAMES AND ADDRESSES

Mr. [REDACTED] Kewanee, Indiana
Mrs. [REDACTED]
Mr. [REDACTED] KOKOMO, Indiana
Mrs. [REDACTED]
Also [REDACTED] and [REDACTED] age's 14 and 10 yrs

24. GIVE THE FOLLOWING INFORMATION ABOUT YOURSELF

LAST NAME, FIRST NAME, MIDDLE NAME

ADDRESS (Street, City, State and Zip Code)

TELEPHONE (Area code and number)

AGE

MALE

FEMALE

INDICATE ADDITIONAL INFORMATION INCLUDING OCCUPATION AND ANY EXPERIENCE WHICH MAY BE PERTINENT.

Husband retired from U.S. Army, 21 yrs.
Both of us are working at RCA in Monticello, Indiana.

25. WHEN AND TO WHOM DID YOU REPORT THAT YOU HAD SIGHTED THIS PHENOMENON?

NAME Harrison A. F. B. DAY 14 MONTH Sept. YEAR 1968

26. DATE YOU COMPLETED THIS QUESTIONNAIRE.

DAY 24 MONTH Sept. YEAR 1968